

FRESNAL BOX
CANYON
SEC. 6
T.16 S., R. 11 E.

HORSE RIDGE
SECS. 9 & 10
T.16 S., R. 11 E.
Plotted from
section described
by M.L. Thompson.

UPPER ALAMO
CANYON
SEC. 6
T.17 S., R. 11 E.

LONG RIDGE
SEC. 15
T.17 S., R. 10 E.

DEADMAN CANYON
SECS. 13 & 14
T.18 S., R. 10 E.

NIGGER ED CANYON
SECS. 6 & 7
T.19 S., R. 11 E.

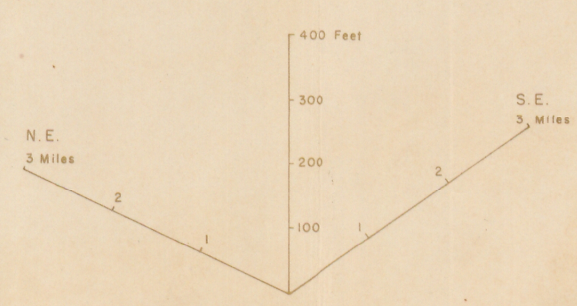

ISOMETRIC PROJECTION

EXPLANATION

SAMPLE LITHOFACIES SECTION		SAMPLE LITHOLOGIC SECTION	
200'		14'	Quartz sandstone, few shale beds
150'		6'	Shale with minor quartz sandstone
100'		5'	Limestone, very sandy
		25'	Covered - probably as below
A = 75%		A = 10	20' Shale, calcareous; interbedded with 1-2' argillaceous limestone
B = 45		A = 10	25' Limestone, massive, upper 10' quartzose calcarenite
C = 10		B = 10	10' Limestone, argillaceous
		A = 10	11' Shale, lower 8' interbedded quartz sandstone
A = Sand and coarser clastics (interformational)		B = 35	10' Quartz sandstone
B = Clay and silt (non-carbonate)		C = 10	
C = Calcite, dolomite plus non-clastic chert.			

LITHOFACIES LOGS OF PENNSYLVANIAN MEASURED SECTIONS OF THE SACRAMENTO MOUNTAINS